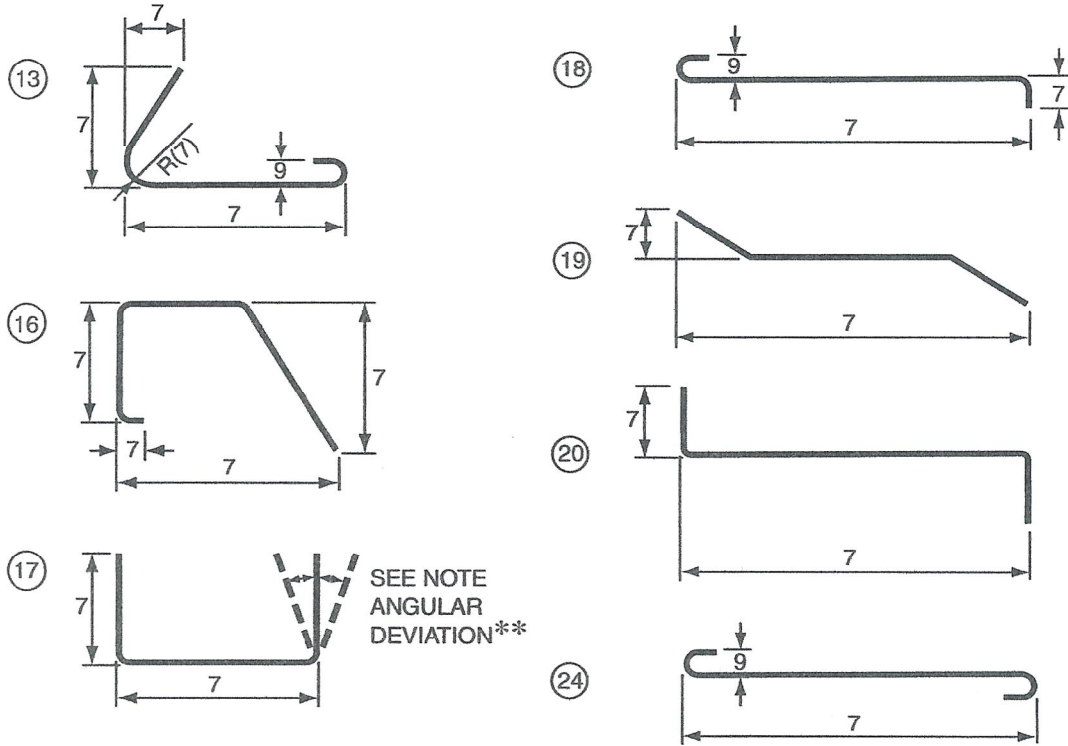

FIGURE 7-4 STANDARD FABRICATING TOLERANCES—ACI 315 (CONT.)
For bar sizes #14 and #18 [#43 and #57]



TOLERANCE SYMBOLS

Symbol	#14 [#43]	#18 [#57]
7	± 2½ in. [65 mm]	± 3½ in. [90 mm]
8	± 2 in. [50 mm]	± 2 in. [50 mm]
9	± 1½ in. [40 mm]	± 2 in. [50 mm]
10 = 2% x "O" dimension, ≥	± 2½ in. [65 mm] min.	± 3½ in. [90 mm] min.

All tolerances single plane and as shown. Also, note end cutting deviations in Section 7.7.

*Saw-cut both ends—overall length ± ½ in. [15 mm].

**Angular Deviation—maximum ± 2½° or ± ½ in./ft [40 mm/m] on all 90° hooks and bends.

***If application of positive tolerance to Bend Type 9 results in a chord length not less than the arc or bar length, the bar may be shipped straight.